

# Pasta Processing Plant

## RSM – RSMX Stainless Steel Manual Bag Openers



12



### Description ▼

For the applications in this sector the RSM Manual Bag Opener is manufactured from stainless steel. It consists of a grille with a rest fitted to its front. The grille is mounted on top of a hopper which is supported by four feet. A fabricated hood with protection door fitted to its front covers the hopper and grille. RSM Bag Openers are manufactured in high-finish-grade materials and come with or without integrated de-dusting filter unit. In the version with integrated dust filter the filter elements are cleaned pneumatically by reverse air jet. For RSMX (ATEX-compliant version) special ATEX devices such as an acoustic alarm and a signal lamp warn the operator in case of an increase in temperature due to an overload of the fan motor.

### Function ▼

The operator puts the bag on the rest and pushes it on to the grille. He then slits the bag open with a vertical cut and shakes it empty. While the bag content may be discharged through a hopper or by BINSWEEP®, a special rotary discharging device, into any type of feeder, the built-in fan operated, air jet cleaned dust collector filters the dust generated during emptying. The empty bag is dropped into the chute on the side which leads into the optional COM-type Waste Bag Compactor (see COM).

Manual RSM Bag Openers are designed to minimise material residue. Due to their modular component design they satisfy a large number of applications.



### Application ▼

RSM Manual Bag Openers are used to transfer raw materials such as additives contained in bags to the mixer or to silos for storage. The material is conveyed pneumatically or mechanically into the mixer or silo.

### Benefits ▼

- ✓ Space-saving overall dimensions and compact user-friendly design;
- ✓ Built-in, fan-operated, air jet-cleaned, maintenance-friendly dust collector;
- ✓ With optional BINSWEEP® Rotary Discharging Device (see chapter);
- ✓ Low overall height;
- ✓ Favourable price-performance ratio.

# Pasta Processing Plant

## RSM – RSMX Stainless Steel Manual Bag Openers



### Technical Features / Performance ▼

- ▶ Material: stainless steel
- ▶ Available with de-dusting filter or equipped for centralised dust suction
- ▶ Filter element options: round bags, elliptical bags made of antistatic filter media in case of ATEX version
- ▶ Filter surface from 3 to 7m<sup>2</sup> (32 to 75 sq ft)
- ▶ Collecting hoppers with different capacity volumes
- ▶ Support feet with possibility of height adjustment
- ▶ ATEX-compliant for zone 22 on request

### Overall Dimensions ▼

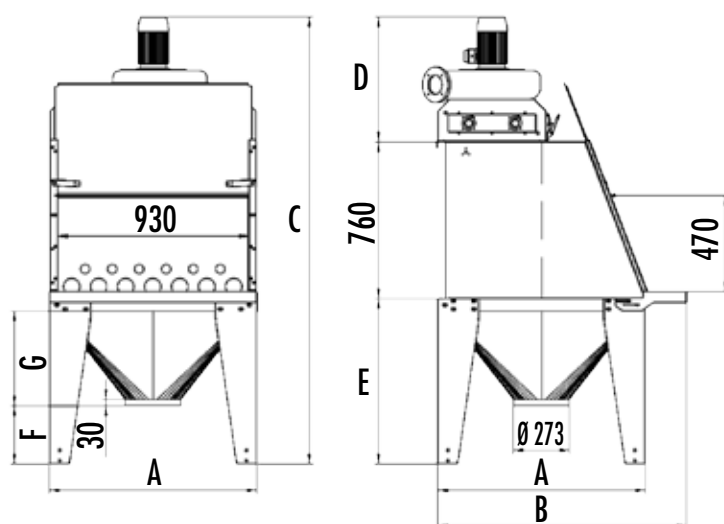

	RSM03
A	1,006
B	1,208
C*	2,166
D*	606
E*	800
F**	282
G**	458

\* Depending on the height of the filter elements and on the type of support feet

\*\* Depending on the hopper model